

**COURSE SYLLABUS – SEMESTER I**  
**BAND I – VI**

**COURSE DESCRIPTION:** Band shall provide students the opportunity to learn and develop, at various stages, the art of instrumental music. A variety of styles, historical time periods, cultures, and genres will be the avenue which students develop their individual performance skills, reading skills, and the significance of music in our cultural heritage as well as in our daily lives. Emphasis on personal skills such as discipline, self-motivation, time management, and team skills will be addressed throughout the school year. **Please refer to the band handbook and class handouts for the specific operations and policies of the band program. You are also referred to the band calendar for the specific activities and events schedule. Note: Both the handbook and the calendar are on the band website along with other important forms and information.**

**EXPECTATIONS:** Each student will be expected to give their best effort on a daily basis. This includes attending all scheduled rehearsals and performances outside of the regular class schedule. Each student will be expected to improve in the areas of reading, terminology, instrumental technique, musicianship, and be able to independently perform their voice part. Each student should be able to offer constructive criticism of performances by the large symphonic/concert bands as well as other performing ensembles. These critiques should address all basic elements of the instrumental art (Tone, Blend, Intonation, Rhythmic accuracy, Technical proficiency, Musicianship, and Musical effect.)

Other expectations include participating in all events, activities, and performances as specified in the band calendar. Students will be given advanced notice of these activities and will be required to attend and participate.

The Band often participates in events that require extended travel. While these trips are the financial responsibility of the student, fundraising events will be scheduled to help students secure the needed funds to cover their expenses.

**STUDENT NEEDS:** A uniform rental fee is required from each student. Furthermore, each student will be responsible for certain accessories and items needed for Symphonic Band dress. In addition, students must maintain their instrument in working condition and supply themselves with the appropriate reeds, accessories, oils, sticks, and mallets as needed for their respective sections and instruments.

**GRADES:** In general, grades will be earned by demonstrating responsible attendance at all Band activities, being able to accurately play your voice part independently and with the ensemble, and a consistent improvement in reading and technical skills. Daily participation will be a consideration in the student's quarterly grade, as will any written exams, assignments, or skills tests. **See Syllabus Attachment A, and B along with the Band Handbook.**

**Class Attendance Policy:**

- Because of the value of **Class Instruction Time**, 100% attendance in class is a minimum expectation.
- On the 4<sup>th</sup> (or subsequent) absence(s), a student will be required to complete a "Make-Up" assignment.
- Make-up assignments must be completed in **14 CALENDAR DAYS**.
- Absences occurring within the last **14 CALENDAR DAYS** of the grading period, assignments **MUST** be made up **NO LATER THEN THE LAST DAY OF THE GRADING PERIOD**.
- In order to receive credit for a make-up assignment, it **MUST** be performed at 80% accuracy.
- If an absence make-up assignment is not completed in the allotted time (14 calendar days), the absence will be counted as unexcused.
- It is the student's responsibility to request make up assignments.
- Please consult Syllabus attachment B regarding excessive class absences.
- Extenuating Circumstances will be considered at the discretion of the Director.

**Class Tardy Consequence/Detention Policy:**

- The Vero Beach High School tardy policy is in effect.

**Performing Arts Performance Review**

- Students will be required to attend and review one (1) arts performance, per semester. This may be a performance from another component of the VBHS Performing Arts Department or a Professional Arts Performance. “Pop Culture” events are not acceptable.
- Students will need to provide an original copy of the ticket stub OR a program of the event AND a Performing Arts Review.
- Students will receive a form that will explain the details of what to include in the Performing Arts Review paper. (Syllabus Attachment H)
- These assignments will be 20% of each of the students SEMESTER EXAM GRADE.
- This assignment may be completed at anytime during the Semester and is Due no later than your semester exam day.

**DUE DATES:** See the Band Calendar for specific due dates for other assignments or items that are listed.

**SYMPHONY ORCHESTRA, CHORUS, & MUSICAL:** From time to time members of the band are needed to provide wind and percussion players for the orchestra, choral accompaniment, and for the pit orchestra for the annual musical. **This is a requirement upon request by the directors for those students in Symphonic Band I, Instrumental Techniques, and Jazz Band, depending upon instrumentation needed.** This responsibility will fall to those students who are musically qualified for the repertoire to be performed and personnel assignments will vary according to the instrumentation needed for the repertoire being performed. Personnel will be rotated for performances in so far as is possible in order to give as many students as possible the opportunity to participate in orchestral performances. Students participating in this capacity will be rewarded with extra credit, special awards and recognition, and possible field trip or travel opportunities in return for their extra service to the Performing Arts Department.

**Chamber Ensembles**

All students are required to participate in chamber ensembles during the course of the school year as assigned. The minimum requirement is participation in at least one ensemble to be performed at the FBA Solo Ensemble Festival or in another venue as assigned. Students will be required to attend after school or evening rehearsals in order to prepare ensembles for performance. Failure to comply with these requirements will result in a substantial lowering of the student's grade.

**Additional Information**

Please refer to **Syllabus Attachments C, E, F, G, and H.**

**COURSE SYLLABUS – SEMESTER I**  
**BAND I – VI (Percussion)**

**COURSE DESCRIPTION:** Band shall provide students the opportunity to learn and develop, at various stages, the art of instrumental music. A variety of styles, historical time periods, cultures, and genres will be the avenue which students develop their individual performance skills, reading skills, and the significance of music in our cultural heritage as well as in our daily lives. Emphasis on personal skills such as discipline, self-motivation, time management, and team skills will be addressed throughout the school year. **Please refer to the band handbook and class handouts for the specific operations and policies of the band program. You are also referred to the band calendar for the specific activities and events schedule. Note: Both the handbook and the calendar are on the band website along with other important forms and information.**

**EXPECTATIONS:** Each student will be expected to give their best effort on a daily basis. This includes attending all scheduled rehearsals and performances outside of the regular class schedule. Each student will be expected to improve in the areas of reading, terminology, instrumental technique, musicianship, and be able to independently perform their voice part. Each student should be able to offer constructive criticism of performances by the large symphonic/concert bands as well as other performing ensembles. These critiques should address all basic elements of the instrumental art (Tone, Blend, Intonation, Rhythmic accuracy, Technical proficiency, Musicianship, and Musical effect.)

Other expectations include participating in all events, activities, and performances as specified in the band calendar. Students will be given advanced notice of these activities and will be required to attend and participate.

The Band often participates in events that require extended travel. While these trips are the financial responsibility of the student, fundraising events will be scheduled to help students secure the needed funds to cover their expenses.

**STUDENT NEEDS:** A uniform rental fee is required from each student. Furthermore, each student will be responsible for certain accessories and items needed for Symphonic Band dress. In addition, students must maintain their instrument in working condition and supply themselves with the appropriate reeds, accessories, oils, sticks, and mallets as needed for their respective sections and instruments.

**GRADES:** In general, grades will be earned by demonstrating responsible attendance at all Band activities, being able to accurately play your voice part independently and with the ensemble, and a consistent improvement in reading and technical skills. Daily participation will be a consideration in the student's quarterly grade, as will any written exams, assignments, or skills tests. **See Syllabus Attachment A, and B along with the Band Handbook.**

**Class Attendance Policy:**

- Because of the value of **Class Instruction Time**, 100% attendance in class is a minimum expectation.
- On the 4<sup>th</sup> (or subsequent) absence(s), a student will be required to complete a "Make-Up" assignment.
- Make-up assignments must be completed in **14 CALENDAR DAYS**.
- Absences occurring within the last **14 CALENDAR DAYS** of the grading period, assignments **MUST** be made up **NO LATER THEN THE LAST DAY OF THE GRADING PERIOD**.
- In order to receive credit for a make-up assignment, it **MUST** be performed at 80% accuracy.
- If an absence make-up assignment is not completed in the allotted time (14 calendar days), the absence will be counted as unexcused.
- It is the student's responsibility to request make up assignments.
- Please consult Syllabus attachment B regarding excessive class absences.
- Extenuating Circumstances will be considered at the discretion of the Director.

**Class Tardy Consequence/Detention Policy:**

- The Vero Beach High School tardy policy is in effect.

**Performing Arts Performance Review**

- Students will be required to attend and review one (1) arts performance, per semester. This may be a performance from another component of the VBHS Performing Arts Department or a Professional Arts Performance. “Pop Culture” events are not acceptable.
- Students will need to provide an original copy of the ticket stub OR a program of the event AND a Performing Arts Review.
- Students will receive a form that will explain the details of what to include in the Performing Arts Review paper. (Syllabus Attachment H)
- These assignments will be 20% of each of the students SEMESTER EXAM GRADE.
- This assignment may be completed at anytime during the Semester and is Due no later than your semester exam day.

**DUE DATES:** See the Band Calendar for specific due dates for other assignments or items that are listed.

**SYMPHONY ORCHESTRA, CHORUS, & MUSICAL:** From time to time members of the band are needed to provide wind and percussion players for the orchestra, choral accompaniment, and for the pit orchestra for the annual musical. **This is a requirement upon request by the directors for those students in Symphonic Band I, Instrumental Techniques, and Jazz Band, depending upon instrumentation needed.** This responsibility will fall to those students who are musically qualified for the repertoire to be performed and personnel assignments will vary according to the instrumentation needed for the repertoire being performed. Personnel will be rotated for performances in so far as is possible in order to give as many students as possible the opportunity to participate in orchestral performances. Students participating in this capacity will be rewarded with extra credit, special awards and recognition, and possible field trip or travel opportunities in return for their extra service to the Performing Arts Department.

**Chamber Ensembles**

All students are required to participate in chamber ensembles during the course of the school year as assigned. The minimum requirement is participation in at least one ensemble to be performed at the FBA Solo Ensemble Festival or in another venue as assigned. Students will be required to attend after school or evening rehearsals in order to prepare ensembles for performance. Failure to comply with these requirements will result in a substantial lowering of the student’s grade.

**Additional Information**

Please refer to **Syllabus Attachments C, E, F, G, and H.**

**PERCUSSION EQUIPMENT RESPONSIBILITIES:** Because of the special nature of the percussion program and the large amount of basic equipment / instruments and the many small accessory instruments / equipment / items necessary to operate the percussion program, it is necessary for members of the percussion section / class / program to be collectively responsible for all equipment / instruments / accessories used at the various times of the year by all students at one time or another. It is understood that it is not possible to assign direct responsibility to any one student or any one specific item at a given time due to the “shared” nature of the equipment and the numerous students that may use the items during the course of a single day. It is understood that all students will share collectively in the responsibility for the replacement of any lost or misplaced equipment / accessories / instruments. Therefore, it is a necessity for all students in the percussion program to be collectively accountable for any items used at any time and any place by any percussionist and for responsibly accounting for all items at the end of each class, rehearsal, performance, or trip.

## SYLLABUS JAZZ BAND I - IV

**COURSE DESCRIPTION:** Jazz Band shall provide students the opportunity to learn and develop, at various stages, the art of jazz. A variety of styles and genres will be the avenue which students develop their individual performance skills, reading skills, and the significance of jazz in our cultural heritage as well as in our daily lives. Emphasis on personal skills such as discipline, self-motivation, time management, team skills will also be addressed throughout the school year. **See band handbook for specifics on the operations of the band program.**

**PRE-REQUISITE:** Jazz Band is a secondary ensemble. Students enrolled in Jazz Band must also be concurrently full participating members of the band program and enrolled in one of the primary band ensembles (Band I – VI)

**EXPECTATIONS:** Each student will be expected to give their best effort on a daily basis. This includes attending all scheduled rehearsals and performances outside of the regular class schedule. Each student will be expected to improve in the areas of reading, terminology, instrumental technique, musicianship, and be able to independently perform their voice part. Each student should be able to offer constructive criticism of performances by the Jazz Bands. These critiques should address all basic elements of the instrumental art (Tone, Blend, Intonation, Rhythmic accuracy, Technical proficiency, Musicianship, Jazz Interpretation, and Musical effect.)

Other expectations include participating in all events, activities, and performances as specified in the Jazz Band calendar. Students will be given advanced notice of these activities and will be required to attend and participate.

**GRADES:** In general, grades will be earned by demonstrating responsible attendance at all Band activities, being able to accurately play your voice part independently and with the ensemble, and a consistent improvement in reading and technical skills. Daily participation will be a consideration in the student's quarterly grade, as will any written exams, assignments, or skills tests. **See Syllabus Attachment A and B along with the Band Handbook.** It is important to quality participation that students have all needed materials and equipment for all class activities as well as all after hours activities.

The Jazz Band often participates in events that require extended travel. While these trips are the financial responsibility of the student, fundraising events will be scheduled to help students secure the needed funds to cover their expenses.

### **Class Attendance Policy:**

- Because of the value of **Class Instruction Time**, 100% attendance in class is a minimum expectation.
- On the 4<sup>th</sup> (or subsequent) absence(s), a student will be required to complete a "Make-Up" assignment.
- Make-up assignments must be completed in **14 CALENDAR DAYS**.
- Absences occurring within the last **14 CALENDAR DAYS** of the grading period, assignments **MUST** be made up **NO LATER THEN THE LAST DAY OF THE GRADING PERIOD**.
- In order to receive credit for a make-up assignment, it **MUST** be performed at 80% accuracy.
- If an absence make-up assignment is not completed in the allotted time (14 calendar days), the absence will be counted as unexcused.
- It is the student's responsibility to request make up assignments.
- Please consult Syllabus attachment B regarding excessive class absences.
- Extenuating Circumstances will be considered at the discretion of the Director.

### **Class Tardy Consequence/Detention Policy:**

- The Vero Beach High School tardy policy is in effect.

**DUE DATES:** See the Band Calendar for specific due dates for other assignments or items that are listed.

**SYMPHONY ORCHESTRA, CHORUS, & MUSICAL:** From time to time members of the band are needed to provide wind and percussion players for the orchestra, choral accompaniment, and for the pit orchestra for the annual musical. **This is a requirement upon request by the directors for those students in Symphonic Band I, Instrumental Techniques, and Jazz Band, depending upon instrumentation needed.** This responsibility will fall to those students who are musically qualified for the repertoire to be performed and personnel assignments will vary according to the instrumentation needed for the repertoire being performed. Personnel will be rotated for performances in so far as is possible in order to give as many students as possible the opportunity to participate in orchestral performances. Students participating in this capacity will be rewarded with extra credit, special awards and recognition, and possible field trip or travel opportunities in return for their extra service to the Performing Arts Department.

## Syllabus Attachment - A

### **2011-2012 Vero Beach High School Band Band Grading Checklist (Guide to Success)**

Your band grade is made up of the following areas:

1. Performance Grade
2. Class Participation Grade

#### Performance Grade:

Your performance grade is determined by the following:

1. Attendance at all non school hour rehearsals.
2. Having all necessary equipment at marching rehearsals.
  - a. The following is required equipment:
    - i. Instrument
    - ii. Flip Folder (with working bar code)
    - iii. Water Bottle
    - iv. Field Markers
    - v. Lanyard with working bar code
    - vi. Correct uniform (see page 24 of the band handbook)
3. Being on time to all non school hour rehearsals.
4. Having all necessary equipment at marching band performances.
  - a. The following is required equipment
    - i. Instrument
    - ii. Flip Folder (with working bar code)
    - iii. Lyre (woodwinds only)
    - iv. Correct performance uniform and personal grooming & appearance (see the band handbook).
5. Attendance at all home and away football games.
6. Attendance at all parades.
7. Attendance at both performances of the winter concert.
8. Attendance at Crown Jewel.
9. Attendance at FBA Marching MPA.
10. Attendance at other band events as listed on the band calendar.

Failure to attend after school rehearsals and scheduled performance may result in the overall band grade dropping. *Please consult the band handbook regarding excused and unexcused absences.*

#### Curricular (Class) Participation

The class participation grade is determined by meeting the following criteria:

1. Being in your seat ready to play when the bell rings (i.e. being on time).
2. Having your instrument every day in class.
3. Playing your instrument in class every day.
4. Having all required music in class every day.
5. Class Attendance - after the second excused absence, make up work must be completed in order to avoid point deduction from the class participation grade.
6. Adequate Musical Progress

Your presence in class every day is needed and expected.

#### Semester Exam Grades

Your semester exam is made up of the following:

1. Playing Audition Score
2. Performance Evaluation Assignment
3. Written Theory Test administered on the exam day (your presence during the exam period is expected)

**Vero Beach High School Band**  
**Fall 2011 Grading Criteria**

Per the VBHS Band Handbook, class grades are determined by the following components:

1. Curricular Participation
  - a. Daily Class Participation
  - b. Musical Progress
2. Laboratory and Practical Application Activities
  - a. Rehearsals
  - b. Performances

Report Card Grades are determined by a student's musicianship, attitude, and participation. Below is a set of criteria used in determining a grade for each student.

---

Students are expected to meet the following criteria:

1. Class participation
  - a. Student has 3 or fewer class absences (subsequent absences - 4 and beyond - are made up).\*\*\*\*
  - b. Student is missing class materials 2 or fewer times.
  - c. Student actively participates in class on a consistent basis (90% of time or higher).
  - d. Musical check offs are completed at the 90% or higher level.
2. After School Rehearsal & Performance grade
  - a. Student is missing required materials 5 or fewer times.
  - b. Student has 2 or fewer unexcused tardies to rehearsals or performances.
  - c. Student actively participates in rehearsals or performances consistently (90%).
  - d. Student consistently (90%) passes marching band inspection on Friday night.

Final 9 Weeks grades are based on the following:

- A letter grade of "A" is earned if the student meets 8 criteria listed above.
- A letter grade of "B" is earned if the student meets 7 criteria listed above.
- A letter grade of "C" is earned if the student meets 6 criteria listed above.
- A letter grade of "D" is earned if the student meets 5 criteria listed above.
- A letter grade of "F" is earned if the student meets no more than 4 of the criteria listed above.

Once the number of criteria met by the student has been calculated, the final 9 weeks grade is determined.

---

NOTE: The final 9 weeks grade may be lowered up to one letter grade for each unexcused absence from a rehearsal. Additionally, the final 9 weeks grade may be lowered up to two letter grades for each unexcused absence from a performance.

In order to receive an "A" for the 9 weeks the student must not have more than 1 excused absence from a performance.

---

\*\*\*\*The final 9 weeks grade may be lowered up to one letter grade if the student has accumulated 7 or more class absences that have not been made up. Make up work for missing class must be completed before the end of the 9 weeks grading period.

## **Vero Beach High School Marching Band Personal Appearance/Grooming Guidelines**

The following guidelines apply to ALL performances involving the Vero Beach High School Marching Band.

1. Visible jewelry and tattoos policy for performances.
  - All tattoos must be covered
  - Jewelry (ear rings and other visible piercings, watches, bracelets, rings) must be removed
    - It is strongly recommended that there be **NO visible jewelry worn**, in the event a student has piercings that may not be reasonably removable, very small studs that **DO NOT** call attention to the individual (either by **size** or **color**) will be allowed
    - PLEASE NOTE – Watches may be worn with rain gear only
2. Hair must be well groomed (men and women).
  - Hair must be a natural color (no neon colors)
  - Hair must be tied up with red hair elastics. Any clips must match hair color
  - Red ribbons must be ¼ inch thick
  - For marching uniforms – hair must fit up into the band hat. If hair will not fit into the hat, it must be tied back using a ¼ inch ribbon. Hair may not hang down past the uniform collar. Flag Corps will wear hair as instructed by the Flag Corp Director
  - Hair color or style must not call attention to the individual
3. Make up
  - Minimal
  - No heavy foundation, eye makeup, or glitter
  - No fingernail polish
  - No dirty fingernails
  - No glitter
  - Guard will wear makeup as instructed by their instructor

Please note that students will not be allowed to perform if these guidelines are not met. There will be an inspection before each performance. Students will have the opportunity to make any needed corrections to their appearance.

Please consult the band handbook for further appearance/personal grooming policies.

## **Marching Band Rehearsal Operational Procedures for Wind and Percussion Students**

### **Arrival to Rehearsal**

- Students should report to rehearsal NO EARLIER than 30 minutes before the start of rehearsal and NO LATER THAN ten minutes before the start of rehearsal (Front Ensemble percussion are not exempt from this policy – please factor in time needed to move equipment)
- Upon arriving at the band room you should do the following:
  1. Go to your locker, retrieve your instrument and other equipment (see attached equipment list).
  2. Unpack your instrument in your designated zone (see attached sheet).
  3. Leave your equipment in your zone and take your instrument case and put it back in your locker. LOCK YOUR LOCKER.
- Playing instruments and Horseplay WILL NOT BE TOLERATED.
- Take care of any music or equipment needs with the Band Librarian or Equipment Manager (they will not help you after ten minutes before the start of rehearsal).
- Absolutely NOTHING is to be left on the main rehearsal room floor or the floor of any storage room or hallway. If you have a large bag, leave it in your zone (see attached map).
- Unless otherwise directed by the Drum Majors, your section leader, or the other Executive Officers, report immediately to the Band Rehearsal Field or other designated place with all of your needed equipment (do NOT hang around the band room).

### **Before & During Rehearsal**

- Attendance will be taken outside the band field gate by scanning in the barcode on your lanyard. Equipment will also be checked outside the gate. IF IT IS NOT WITH YOU, IT IS COUNTED AS YOU NOT HAVING IT. Please have these materials readily available, the attendance secretaries will not wait.
  - o NOTE: When a student's bar code becomes worn, it is their responsibility to get a new one
- All rehearsals will most likely begin in a warm up block or a designated page of drill. If you are not in the block at exactly when the whistle blows to start rehearsal, YOU ARE LATE.
- Break times include moving to and from the field. A 5 minute break means that you are back in your place at the end of 5 minutes.
- Be sure that you place your water bottle with your section's bottle. All water bottles should be lined up neatly. If you are instructed to place your horn on the sideline, it must be lined up neatly (all going in the same direction) with the other instruments in your section.
- RESPECT STUDENT LEADERS AND ADULTS AT ALL TIMES.
- If you need to use the rest room, check out with your section leader and go QUICKLY.
- Always move quickly and with a sense of urgency in a rehearsal. REMEMBER: The faster you move, the more we get done and the better we become.

### **After Rehearsal**

- Be sure to gather all of your belongings from the field. DO NOT LEAVE ANYTHING BEHIND.
- Report back to the band room. NO PLAYING ONCE YOU LEAVE THE REHEARSAL FIELD.
- Upon arriving back to the band room, pack up your instrument and put away all of your equipment. REMEMBER: Water bottles, clothes, and food are NOT to be kept in your locker.
- Before you leave, be sure that you have ALL of your stuff. Anything left in ANY part of the band room will be collected by the leadership team and directors and taken to the school lost and found OR thrown away.
- Horse play WILL NOT be tolerated.
- CLEAN UP AFTER YOURSELF. WE DO NOT HAVE A MAID!!!!!!

### **Equipment Needed for Rehearsal**

1. Marching Instrument
2. Field Markers (4)
3. Lanyard
4. Flip Folder
5. Water Bottle

Part of your band participation grade is based on your having ALL of these items.

**Dress for Rehearsal – Winds and Percussion**

TUESDAY NIGHTS

White football season (current year) T-Shirt, Black or dark navy shorts (athletic shorts are acceptable) that are finger tip length or longer, white shoes, and white socks. NO HEADGEAR. Long hair for MEN and WOMEN should be tied back in a pony tail.

THURSDAY NIGHTS

Gray band shirt with the RED Indian on the back (Black or dark navy shorts (athletic shorts are acceptable) that are finger tip length or longer, white shoes, and white socks. NO HEADGEAR. Long hair for MEN and WOMEN should be tied back in a pony tail.

Rehearsal Dress and Equipment will be checked outside the band field gate. Failure to have all items or the correct uniform will result in points deducted from your band grade.

## **Marching Band Traffic Flow and Zones**

Lockers 1A, 2A, 15A, 16A – ZONE 4

Lockers 17A through 29A – ZONE 1

ALL Percussion – ZONE 2

Lockers 91C through 93C & 119D through 153D – ZONE 3

Lockers 69B through 80B – ZONE 4

Lockers 30A through 38A & 107C through 118C – ZONE 5

Upstairs Locker Room – Your Zone is the locker room upstairs

Students are to unpack their instrument in their assigned zone. Additionally, students are to put on their uniform and keep their hangers in their zone. Students are NOT to go into other zones. Once students have finished rehearsal or performance preparation, students should move to the practice field or game assembly area.

## **Storing Personal Belongings**

Personal belongings are NOT to be stored in the large rehearsal hall or small ensemble room except in a locker. All students have been issued a locker. Students with large lockers should keep bags and personal belongings in their lockers. Students with small lockers may keep their personal bags in the computer lab on game nights. For Tuesday and Thursday nights students are to keep all personal bags in the computer lab. ALL ITEMS SUCH AS PURSES, WALLETS, CELL PHONES, AND OTHER VALUABLE ITEMS SHOULD BE KEPT LOCKED IN LOCKERS. The Vero Beach High School Band is not responsible for lost or stolen items left in the band room.

## **Storing Marching Band Hats and Hangers**

Students are expected to neatly stack all hat boxes in their respective zone. Additionally, all uniform hangers are to be placed in plastic bins in each zone. Hangers and hat boxes are not to be kept in lockers or placed on percussion instruments.

Syllabus Attachment F

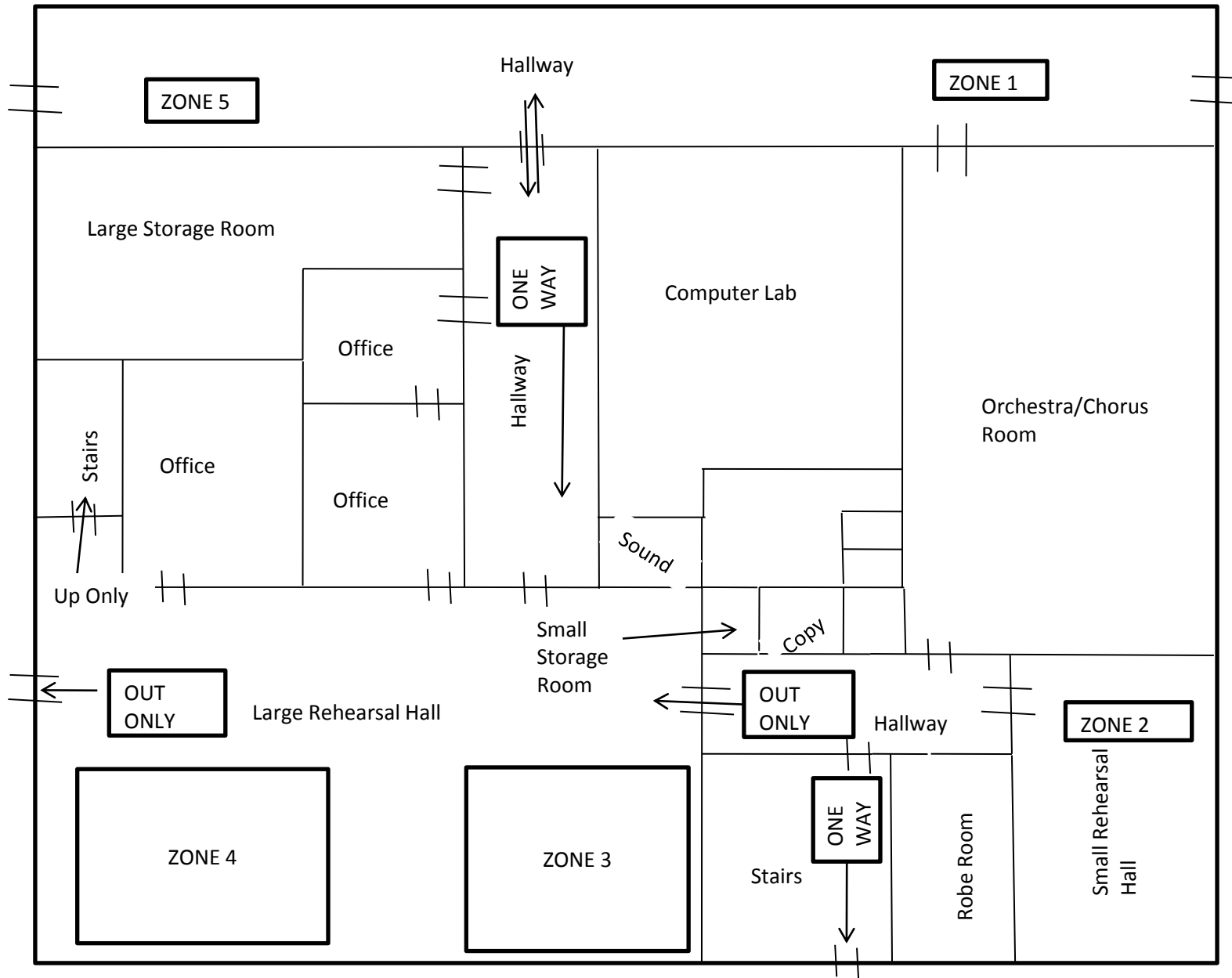

## **Vero Beach High School Band After School Performance/Rehearsal Attendance Policy**

100% attendance is the minimum requirement for all after school rehearsals and performances. Due to the nature of band, one person missing from a rehearsal or performance has a negative effect on the entire band. Please refer to the band handbook for detailed attendance policies. The following is a brief description of the attendance policy.

### After School Rehearsals and Performances

In the event you must be absent from a rehearsal or performance:

1. Review the band handbook to see if your absence meets the specified requirements for excused absences.
2. Complete a Pre Arranged Absentee Request form. (located above the water fountain in the band room or on the band website under student information).
  - a. Please note: Pre Arranged forms must be in the director's hands 7 days in advance of rehearsals and 21 days in advance for performances.
  - b. FAILURE TO COMPLETE ONE OF THESE FORMS AND TURN IT IN TO THE BAND DIRECTOR WILL RESULT IN THE ABSENCE BEING COUNTED UNEXCUSED.

In the event an emergency arises or you are ill and must miss a rehearsal:

1. Call the band office (564-5413) and leave a message or send an email to [veroband@yahoo.com](mailto:veroband@yahoo.com)
2. Complete an Emergency Absence Request Form (located above the water fountain or on the band website).
  - a. This form should be in the hands of the director within 3 days of the student's return.
  - b. FAILURE TO COMPLETE THIS FORM AND TURN IT IN TO THE BAND DIRECTOR WILL RESULT IN THE ABSENCE BEING COUNTED UNEXCUSED.

### Policy on After School Rehearsals and Athletic Games/Meets (and other School Activities)

Students are permitted to miss rehearsals for athletic games/meets (or other school related activities) provided they complete a Pre Arranged Absentee Request Form. However, students are expected to be present at rehearsals during the week of Crown Jewel, FBA Marching MPA, District/State Concert MPA, and other major performances. Excessive absences for other school activities are not permitted. Please consult the band handbook regarding this policy.

**PLEASE NOTE:** Per handbook policy if a student has an unexcused absence for a Tuesday and/or Thursday rehearsal, they may not perform at half time with the band. Students who do not perform on the field will perform from the sideline during the halftime performance.

# VBHS Performance Review / Evaluation

Student Name: \_\_\_\_\_

Event Title: \_\_\_\_\_

Event Date: \_\_\_\_\_

*Provide an original or a copy of the ticket stub or program from the event for attendance proof.  
Your Patron of the Arts Performance Review should be typed and attached to this form.*

**Purpose:** No matter what your future occupation may be, becoming a Patron of the Arts is an experience that may be enjoyed throughout your entire life.

**Goal:** To witness an artistic event, think critically about it, and then express your ideas on paper.

**Assignment:** Concert Review (20% of semester exam) Each VBHS Performing Arts student is expected to attend one (1) artistic performance per semester in which he or she does not perform. This event may be a professional event, or a school event. The concert should allow you at least an hour to experience the event. The concert review must be typed. You must submit a program or ticket stub if one is available. To keep this experience fresh in your mind, please submit your Patron of the Arts Performance Review within 7 days of the performances. If there is a hardship for you to attend a performance, see your teacher ASAP for an alternative.

Attach your type-written responses to the following questions:

1. Describe your favorite selection from the program. Why did this piece appeal to you? If this was a play or musical, describe the intent of the story line.
2. Describe a unique aspect of the performance. Was it a traditional concert set-up? Did something catch your eye that made the performance special? If this was a play or musical, describe specific aspects of the performance: set, technical, acting, costumes, etc.
3. Through the program notes, director's comments, or performance practices, what did you learn about one of the selections?

## Assessment Rubric for Patron of the Arts Performance Review

IDEAS AND CONTENT (FOCUS AND ELABORATION)	
❖	Clear and focused.
❖	Relevant and quality details enrich the central ideas.
❖	Goes beyond the obvious
❖	Thorough explanation of support/reasoning
❖	Personal reflection
50-46 point	<b>Strong</b> —shows control and skill in this trait: many strengths present
45-41 points	<b>Competent</b> —on balance, the strengths outweigh the weaknesses: a small amount of revision is needed
40-36	<b>Developing</b> —strengths and need for revision are about equal: about half-way home
35-33	<b>Emerging</b> —need for revision outweighs strengths; isolated moments hint a what the writer has in mind
32 - below	<b>Not Yet</b> —a bare beginning
0	<b>Incomplete</b> —no effort

**General Personal Appearance and Grooming for Concerts**  
**Symphonic Band I –II –III & Jazz Bands I – II - III**

It is of high importance for the band to present a dignified professional image during public events. Our school and boosters have gone to great expense and effort to provide the band with professional style uniforms and it is only appropriate that the personal grooming and appearance of individual members appropriately match and blend into the quality and professional image of our performance uniforms and dress. It is for this reason that we have adopted the following polices.

1. **NO** visible tattoos – please cover appropriately so as **NOT** to call attention to them;
2. While it is strongly recommended that there be no visible jewelry worn, in the event where a student has piercings that may not be reasonable removable, very small studs that **DO NOT** call attention to the individual (either by **size** or **color**) will be allowed;
3. **NO** visible bracelets and rings that either **call attention** to the individual or **might interfere** with the playing of the instrument will be allowed;
4. Hair must be well groomed;
  - Use small hair elastics, ribbons, & clips that match hair color (**these must not call attention to the individual**);
  - Small Ribbons (thin ¼ inch max)
  - Hair style must be neat and must not cover the face;
  - Hair color or style must **NOT** call attention to the individual;
5. Make Up;
  - Minimal general make up only; Must **NOT** call attention to the individual:
  - Minimal foundation and eye color (neutral color only)
  - No colored fingernail polish (clear or neutral only)
  - Fingernails clipped and clean
  - No Glitter of any kind

For questions regarding uniforms, shoes, hosiery, socks, or other accessories to the formal uniforms, please refer to the Concert Uniform Informational Handout or ask the band directors well in advance of the performance. Drama and emotional upsets over personal grooming, dress, and uniform issues prior to a performance situation reduce the level of performance and the enjoyment of the performance for all concerned. Please be responsible and plan for performance dress and appearance well in advance.

## General Classroom Procedures

Applicable to all bands and classes...

- All school rules will be enforced at all times and in all areas of Building 4 and the Performing Arts Center. School Dress Code is expected at all times. The school tardy policy will be followed (see school code of conduct)
- All students must be in the band room when the tardy bell sounds. Students should use the restroom and attend to any other business prior to reporting to class. No student will be admitted after the tardy bell rings without an admission slip from the office or from another teacher.
- Upon entering the rehearsal hall (only through the central hallway door), each student should quietly and quickly acquire his/her instrument, music, and other materials needed for rehearsal. Each student is expected to then go directly to his/her assigned seat, check the white board or video for instructions / information and begin warming-up properly on their instrument. Only those students who have assigned lockers are allowed upstairs. Please do not hang out in instrument storage rooms, move out as quickly as possible to the rehearsal hall. Horseplay, socializing, cell phone use, texting and such is not allowed. Rehearsal time is valuable.
- Period 2, 3, 4, 5, 6, and 7 students are expected to be in their assigned seats with all necessary materials no later than 2 minutes after the tardy bell sounds. Period 1 students are expected to be in their assigned seats or area with all materials and instruments ready to begin class when the tardy bell sounds. Period 6 and 7 FLC students are expected to be in their assigned seats or area with all materials and instruments ready to begin class 3 minutes after the arrival of the shuttle bus. In any case, students must be in their seats with all necessary items when the conductor or designated student leader begins the ensemble warm-up. **Violators will be considered tardy.**
- Prior to the start of rehearsal, students should warm-up their instruments by playing long tones and exercises from the designated warm-up books and materials. After your instrument is warmed up, then check the tuning of the instrument with a tuning device. Only appropriate warm-up exercises or passages from the music being rehearsed should be played before rehearsal formally begins.
- Gum, candy, food and other such items are not allowed in Building 4 or the Performing Arts Center due to hazards of health and damage to the instruments or facilities.
- Effective rehearsals and classes require silence and focus from everyone with the exception of appropriate and necessary communication and interactions. Distractions and interruptions that interfere with instruction and rehearsal are unacceptable.
- In the event a student should need to leave during class, an appropriate school pass is required for dismissal. Students, who need to occasionally leave class to go to the rest room (in Building 4 only), may do so on the “honor system” by signing in and out of class in the log book. Students are expected to return to class as promptly as possible.

- Students who come to class without necessary materials which includes instruments, music, pencils, paper, accessories, and necessary equipment, or who choose not to participate on a quality basis will lose points off their class participation grade.
- From time to time, rehearsals and class may be held in the Performing Arts Center. All rules applicable to Building 4 apply to the Performing Arts Center. Upstairs and back stage areas in the PAC are strictly off limits to all students. Never go in these areas without the expressed and specific permission of one of the Band Directors or the Director of the Performing Arts Center. Violators can expect definite consequences.
- At the end of each rehearsal or class activity each student is to **case** their own instrument in their assigned locker. Remember to **LOCK** your locker properly. Music, mutes, accessories, and other equipment are to be returned to their appropriate storage places. Chairs and stands must be racked and stacked. Individuals or class who are continually negligent regarding chairs and stands can expect consequences for their lack of cooperation. NO items may be left out of place. Items left out irresponsibly are not the responsibility of the band staff and will be placed in the “***bucket of irresponsibility***”. All unclaimed items are dispensed with weekly.
- Students must leave the band room immediately after class unless specifically held back by one of the Band Directors. Do not plan to hang around after class or drag out the process of putting away your equipment and such. Late passes will not be issued, please do not ask. You must get to your next class on time. Band will not be used as an excuse for being tardy elsewhere on the campus.